

# FR90 SLIDE

## FR90 SLIDE

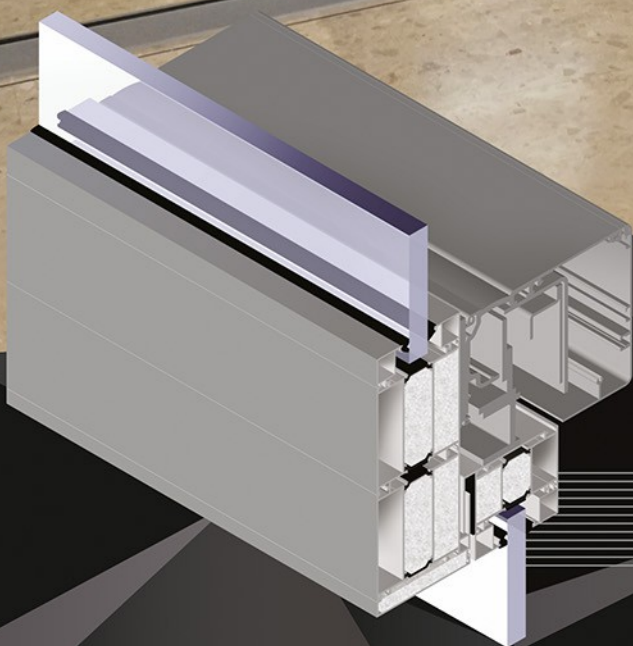

Thermally insulated automatic fire-rated door system structures based on the FR90 SLIDE system can be applied in public and commercial buildings.

# FR90 SLIDE

Thermally insulated automatic fire-rated door system structures based on the FR90 SLIDE system provide the EI30 fire resistance class according to PN-EN 13501-2 of 2016.

## Characteristic of construction:

- chambers of the profiles are filled with fireproof inserts
- universality and unification of profiles with the FR90 system
- esthetic labyrinth connection of the sashes
- symmetrically glazing
- maximum dimensions of the structure 4900 mm x 3500 mm
- maximum dimensions of the leaf glass pane: 1193,5 x 2339 mm
- maximum dimensions of sash: 1369 x 2472 mm (joggle connection)
- dedicated automation solution: DORMA, GEZE
- structures:
  - double door,
  - sliding externally,
  - side and top lites.

FR90 SLIDE system can be applied in public and commercial buildings.

A wide range of colours – RAL palette (Qualicoat 1518), structural colours, Aliplast Wood Colour Effect (Qualideco PL-0001), anodic (Qualanod 1808) and two-coloured.

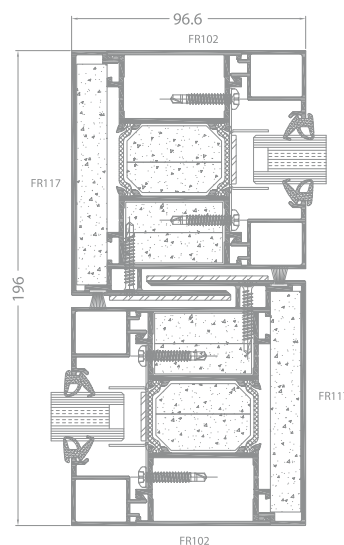

FR90 SLIDE

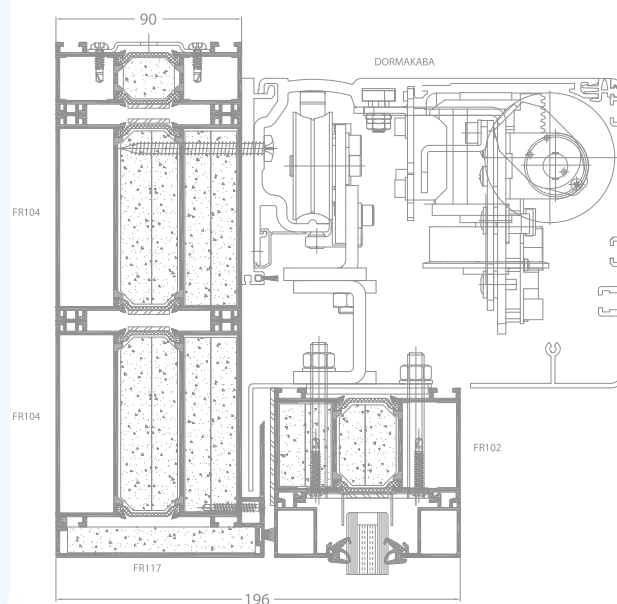

Joint through the sliding leaf with automatic drive

## TECHNICAL SPECIFICATION

SYSTEM	MAXIMUM DIMENSIONS OF THE DOOR LEAF (L x H in mm)	MAX DIMENSIONS OF THE LEAF GLASS PANE	STRUCTURE TYPE	FIRE RESISTANCE CLASS
FR90 SLIDE	1369 x 2472 mm	1193,5 x 2339 mm	double door, sliding externally, side and top lites	EI 30 /PN-EN 1634-1+A1:2018-03