

SP 800 i+

**SUPERIAL 800 i+**

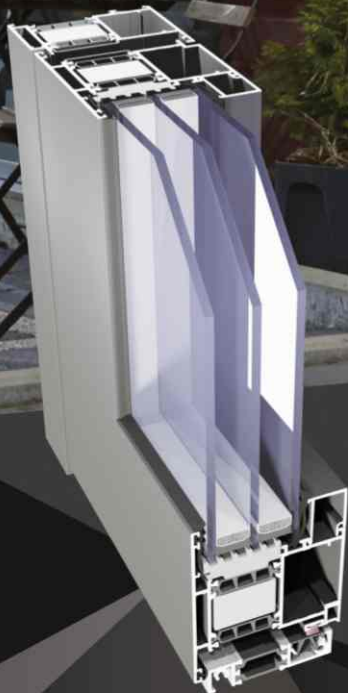

A door system designed for doors with high thermal insulation parameters.

# SP 800 i+

A door system designed for doors with high thermal insulation parameters.

The system is compatible with system the Superial system - thanks to adaptive profiles designs in series SP 800 can be integrated with Superial shop windows.

The system features very good anti-burglary properties (the lock is situated far from the outer side).

A thermal insulation threshold is used, which can be disassembled following door installation in the frame.

The option of bending profiles (detailed specification of profiles and detailed technical parameters of a profile bending process are available in the customer area of the website [www.aliplast.pl](http://www.aliplast.pl)).

System SP800 is also available in the variant with improved thermal insulation power (SP 800 i, SP 800 i+), which was achieved by applying special thermal inserts slid between thermal separators and around the glass pane. Such a solution improves the insulating power of the profile by 0,2 – 0,5 W/m<sup>2</sup>K.

There is possibility of use Flyscreen system (Flyscreen – fly screens are a practical and an extremely functional protection against insects.)

Wide range of colours – RAL palette (Qualicoat 1518), texture colours, Aliplast Wood Colour Effect (wood-like colours), Aliplast Loft View – colours imitating stone surfaces (Qualideco PL-0001), anodized colour (Qualanod 1808), bi-colour.

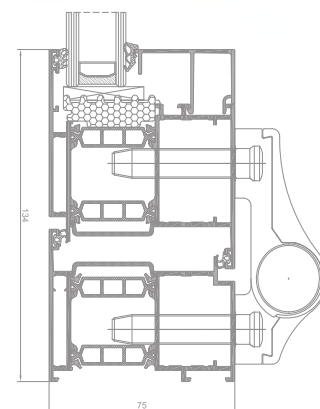

SP 800 i door section

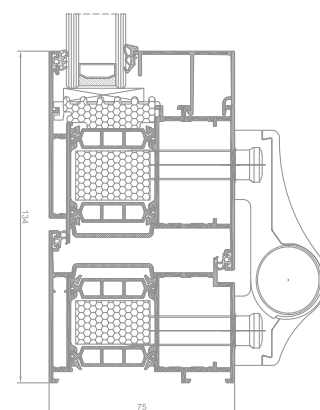

SP 800 i+ door section

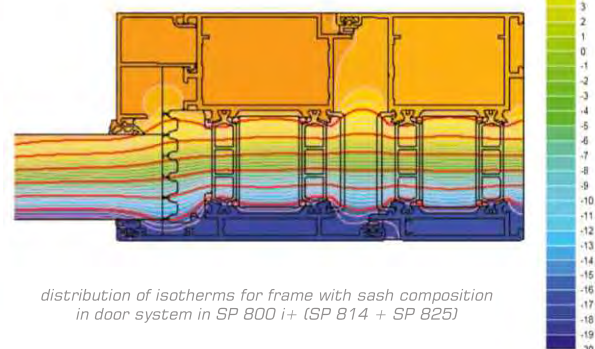

distribution of isotherms for frame with sash composition in door system in SP 800 i+ (SP 814 + SP 825)

## TECHNICAL SPECIFICATION

SYSTEM	DEPTH OF FRAME	DEPTH OF LEAF	GLAZING RANGE	ACOUSTIC	MAXIMUM WINDOW SIZES	MAXIMUM DOOR SIZES
SP 800	75 mm	75 mm	14-61 mm	44 (0,-2) dB	—————	single-leaf door 1300 x 2800 mm double-leaf door 2500 x 2800 mm
SP 800 i+	75 mm	75 mm	14-61 mm	44 (0,-2) dB	—————	single-leaf door 1300 x 2800 mm double-leaf door 2500 x 2800 mm

## PERFORMANCE

SYSTEM	THERMAL INSULATION Uf *	AIR PERMEABILITY	WINDLOAD RESISTANCE	WATERTIGHTNESS
SP 800	Uf from 1,61 W/m <sup>2</sup> K	Class 4; EN 12207	CE 2400 (2400 Pa); EN 12210	Class 8A; EN 12208
SP 800 i+	Uf from 1,36 W/m <sup>2</sup> K	Class 4; EN 12207	CE 2400 (2400 Pa); EN 12210	Class 8A; EN 12208

\* Thermal insulation is dependent on a combination of profiles and thickness of the filling.